

SVP positions in abeyance to be reviewed

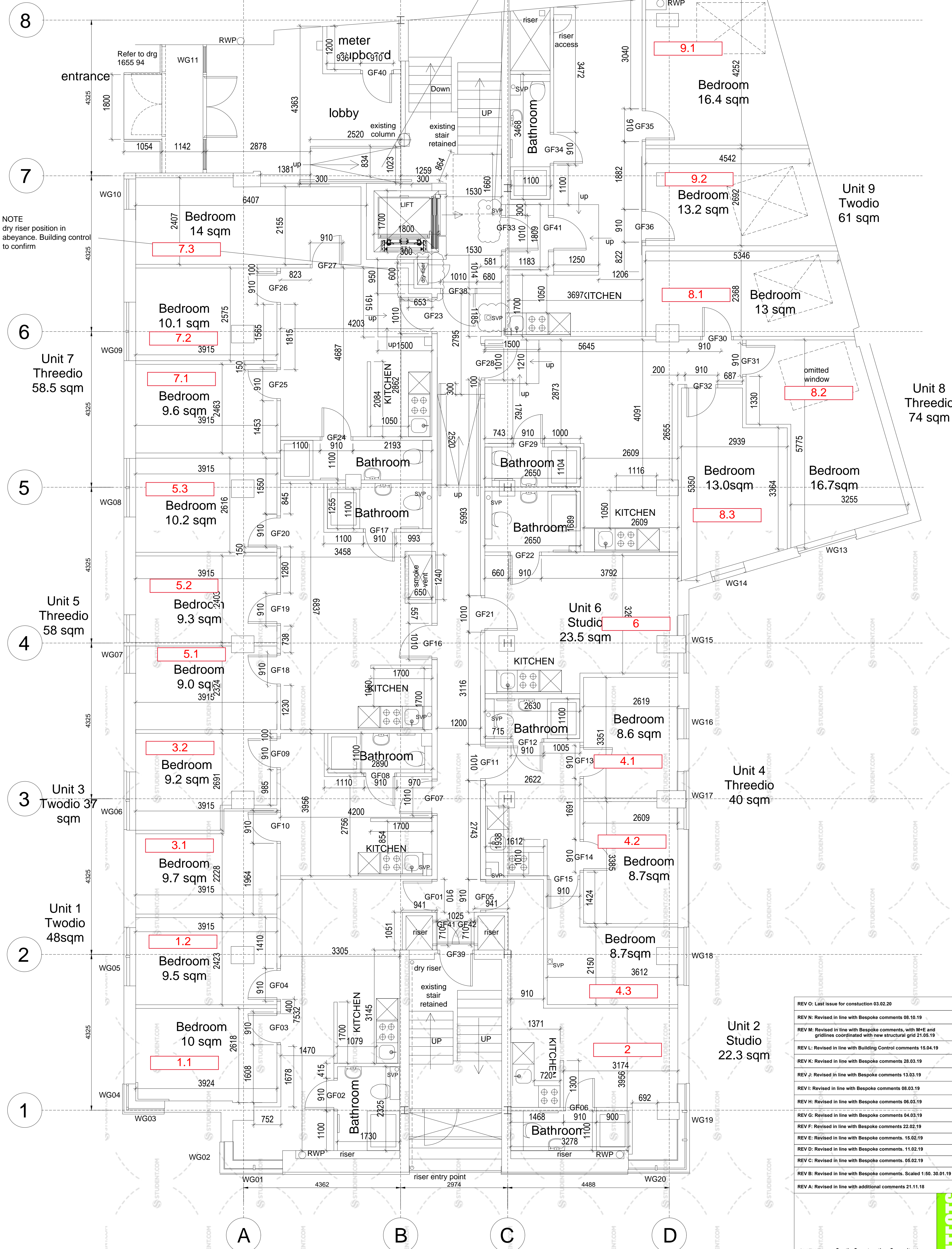

NOTE  
dry riser position in  
abeyance. Building control  
to confirm

REV O: Last issue for construction 03.02.20
REV N: Revised in line with Bespoke comments 08.10.19
REV M: Revised in line with Bespoke comments, with M+E and gridlines coordinated with new structural grid 21.05.19
REV L: Revised in line with Building Control comments 15.04.19
REV K: Revised in line with Bespoke comments 28.03.19
REV J: Revised in line with Bespoke comments 13.03.19
REV I: Revised in line with Bespoke comments 08.03.19
REV H: Revised in line with Bespoke comments 06.03.19
REV G: Revised in line with Bespoke comments 04.03.19
REV F: Revised in line with Bespoke comments 22.02.19
REV E: Revised in line with Bespoke comments 15.02.19
REV D: Revised in line with Bespoke comments 11.02.19
REV C: Revised in line with Bespoke comments 05.02.19
REV B: Revised in line with Bespoke comments. Scaled 1:50. 30.01.19
REV A: Revised in line with additional comments 21.11.18

CLIENT: Castle Construction Consultants  
PROJECT: Greyfriars Coventry  
DWG TITLE: Proposed ground floor setting out

DATE: 01.11.18  
DRAWN BY: ML/DGB  
SCALE: 1:50  
JOB NO: 1655  
DWG NO: 605

Dimensions shown must be checked on site prior to manufacture by contractor. If bearing is not to be scaled from. Any discrepancy should be reported immediately to the designer. This drawing is not to be copied or disclosed to any third party without the consent of

**LUCAS ARCHITECTS**

Proposed ground floor